



**Note: These items are not included in this package.**

1. Mainboard
2. RAM
3. Wireless Card
4. Slim Type Optical Drive

**Size: 193.5(222.8) x 196.0 x 79.8 mm**

### 1. Summary

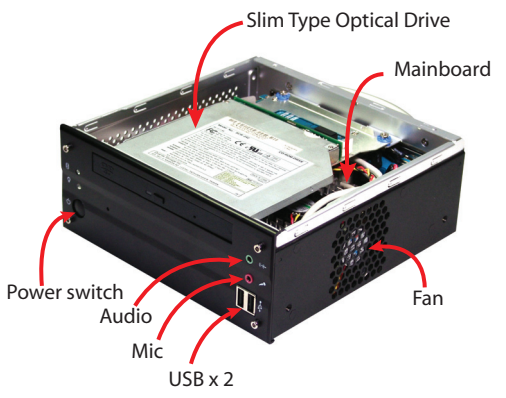

### 2. Install I/O Gasket

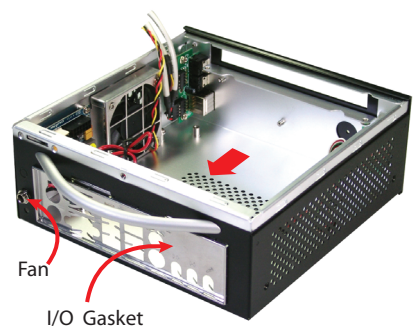

1 - Assemble I/O gasket as showing.

### 3. Install Wireless Card (optional)

A: M2x3mm I head screws (x2)

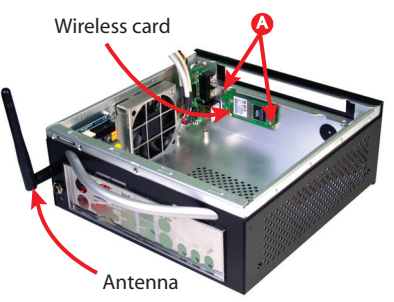

1 - Place wireless card to chassis with M2x3mm screws (x2).

### 4. Install Mainboard

B: M3x5mm hex head screws (x4)

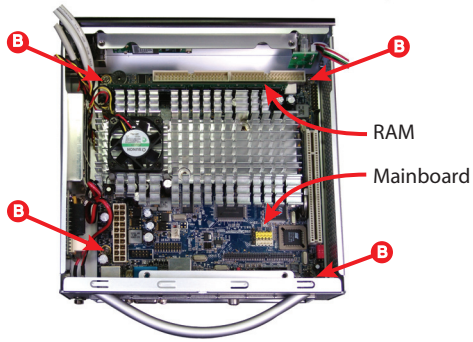

1 - Place mainboard to chassis with M3x5mm screws (x4).  
2 - Please refer to mainboard manual to install RAM.

### 5. Install 2.5" HDD

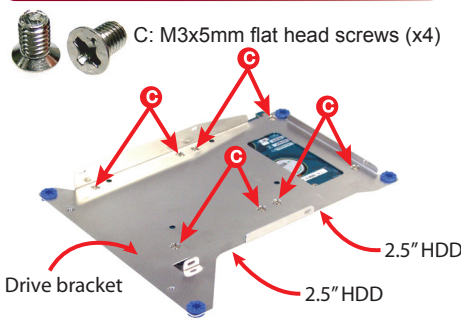

1 - According to your HDD quantities to secure flat head screws (x4) or flat head screws (x8) from above.

### 7. Install Drive Bracket

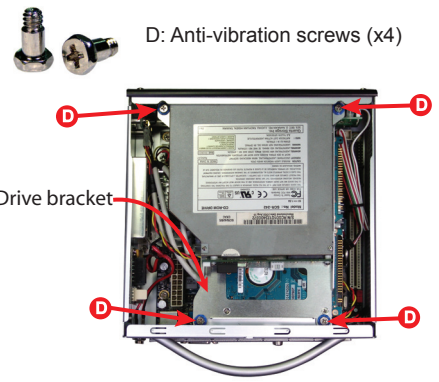

1 - Install drive bracket as shown.  
2 - Secure anti-vibration screws (x4).

### 6. Install Slim Type Optical Drive

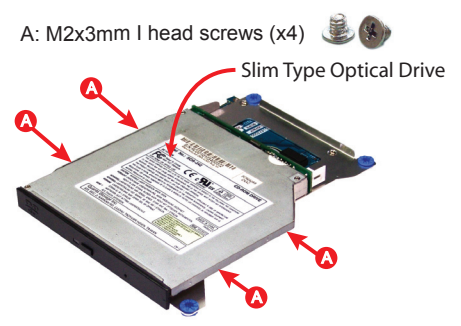

1 - Secure I head screws (x4) from both sides.

### 8. Close Top Cover



1 - Close top cover.  
2 - Secure thumb screw (x1).

### Safety Cautions

SAFETY STEPS: When removing the chassis cover to access the system components, follow the safety precautions below:



1. Turn off all peripheral devices connected to the system.
2. Turn off the system by pressing the power button.
3. Unplug all AC power cords from the system or from wall outlets.
4. Label and disconnect all cables connected to I/O connectors or ports on the back of the system.
5. Wear an antistatic wrist strap grounded to the chassis -- any unpainted metal surface -- when handling components.
6. Do not turn on the system when the chassis cover is open.

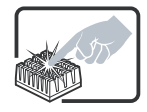

The microprocessor and heatsink may be hot if the system has been running. Also, there may be sharp pins and edges on some board and chassis parts. Contact should be made with care. Consider wearing protective gloves.